

**PLAN SHOWING LEASE BOUNDARY OF T.C. No. 28 of 1953 ON GEOREFERENCED & VECTORISED CADESTRAL MAP  
SITUATED IN VILLAGE SARVONA, BICHOLIM TALUKA OF NORTH GOA DIST.,GOA**

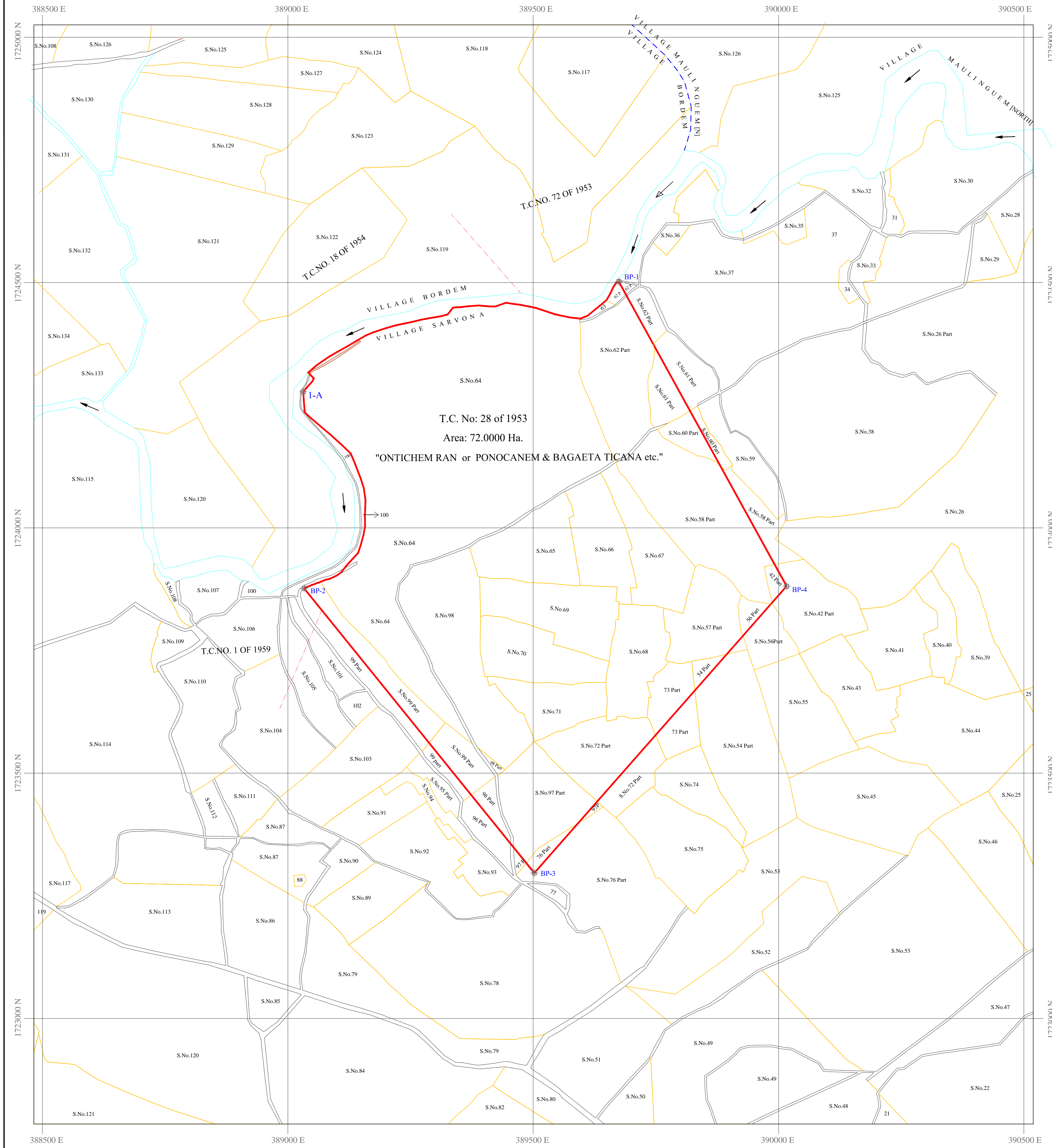

| B.P.No. | LATITUDE           | LONGITUDE          | EASTING    | NORTHING    |
|---------|--------------------|--------------------|------------|-------------|
| 1       | 15° 35' 45.1968" N | 73° 58' 15.3480" E | 389674.506 | 1724501.979 |
| 2       | 15° 35' 24.7860" N | 73° 57' 53.9136" E | 389033.074 | 1723876.938 |
| 3       | 15° 35' 5.9424" N  | 73° 58' 09.7608" E | 389502.270 | 1723296.521 |
| 4       | 15° 35' 25.0440" N | 73° 58' 26.9292" E | 390016.448 | 1723881.034 |
| 1-A     | 15° 35' 37.7880" N | 73° 57' 53.7948" E | 389031.480 | 1724277.420 |

| SURVEY NUMBER WISE AREA WITH IN MINING LEASE |           |               |
|--|-----------|---------------|
| Village                                      | Survey No | Area in Ha.   |
| Sarvona                                      | 42 Part   | 0.1890        |
| Sarvona                                      | 54 Part   | 0.1740        |
| Sarvona                                      | 56 Part   | 0.2445        |
| Sarvona                                      | 57 Part   | 2.2385        |
| Sarvona                                      | 58 Part   | 5.4040        |
| Sarvona                                      | 60 Part   | 0.5500        |
| Sarvona                                      | 61 Part   | 0.7230        |
| Sarvona                                      | 62 Part   | 3.7300        |
| Sarvona                                      | 63        | 0.0550        |
| Sarvona                                      | 64        | 26.2885       |
| Sarvona                                      | 65        | 2.6725        |
| Sarvona                                      | 66        | 2.4325        |
| Sarvona                                      | 67        | 2.4675        |
| Sarvona                                      | 68        | 2.3000        |
| Sarvona                                      | 69        | 3.0825        |
| Sarvona                                      | 70        | 2.4400        |
| Sarvona                                      | 71        | 1.8725        |
| Sarvona                                      | 72 Part   | 2.3385        |
| Sarvona                                      | 73 Part   | 0.9055        |
| Sarvona                                      | 76 Part   | 0.2345        |
| Sarvona                                      | 96 Part   | 0.3275        |
| Sarvona                                      | 97 Part   | 2.8170        |
| Sarvona                                      | 98        | 5.3550        |
| Sarvona                                      | 99 Part   | 2.3850        |
| Sarvona                                      | ROAD      | 0.7730        |
| TOTAL  |           | 72.0000 (Ha.) |

| LEGEND:- |                                   |
|----------|-----------------------------------|
|          | DGPS POINT OF LEASE BOUNDARY      |
|          | LEASE BOUNDARY AS PER DGPS SURVEY |
|          | VILLAGE BOUNDARY                  |
|          | SURVEY No. BOUNDARY               |
|          | ROAD                              |
|          | NALLA                             |

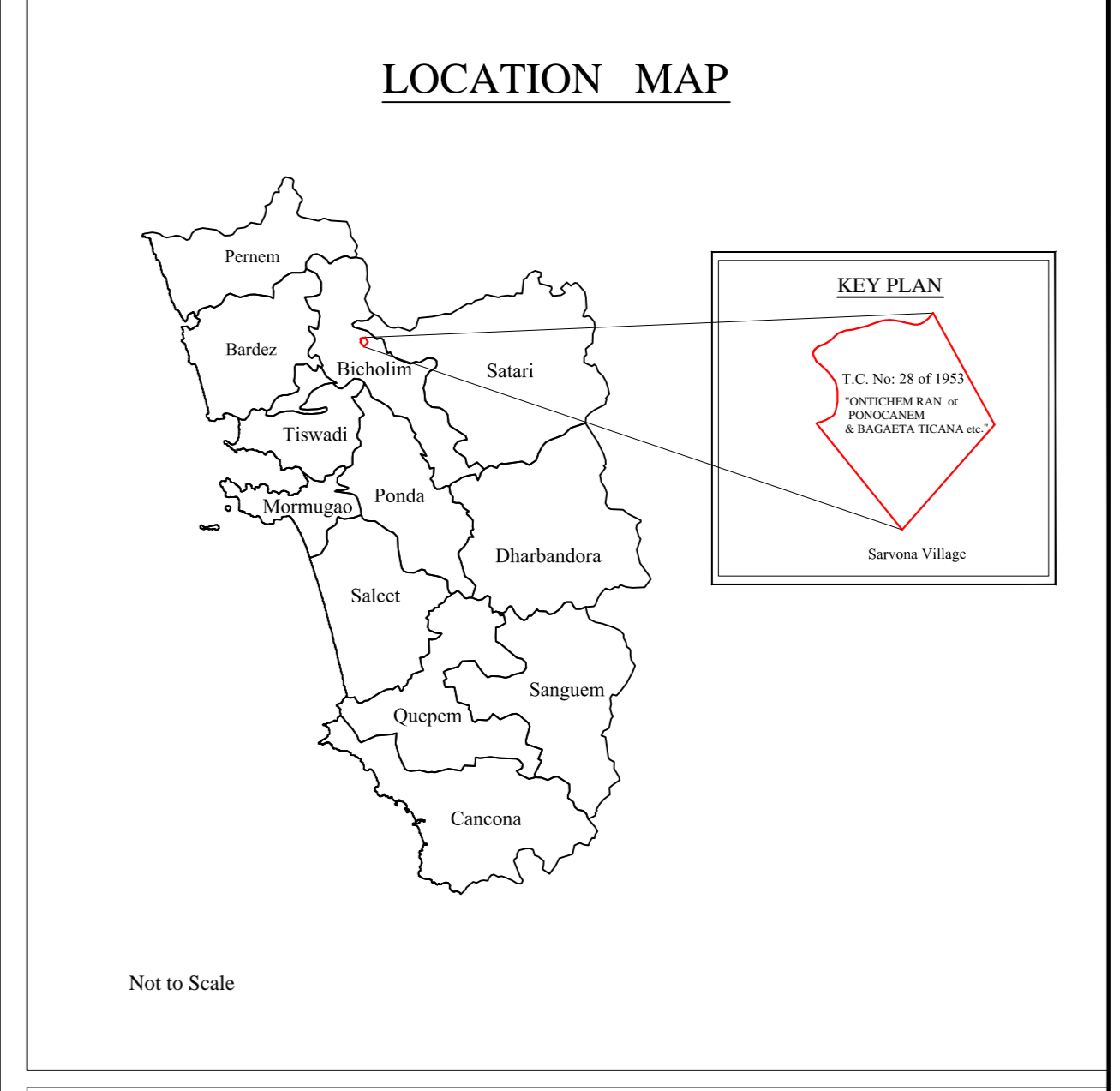

MAP DATUM : WGS 84  
PROJECTION : UTM Zone : 43 North

Geo Referenced & Vectorised Cadastral Map of **T. C. No : 28 of 1953**  
Lease Name : "ONTICHEM RAN or PONOCANEM & BAGAEETA TICANA etc"  
Lessee:- **ZANTYE & CO. PVT. LTD.**  
Sited in Village **Sarvona** of Bicholim Taluka,  
North Goa District, Goa State.  
Lease Area : **72.0000 Ha.**

SURVEYED & PREPARED BY  
M/s. GEOFINY TECHNOLOGIES (P) LIMITED  
No.352/1B, RAJIV GANDHI SALAOMR, TAMBARAM TALUK,  
CHENNAI-600 119

Empanelled by  
Directorate of Mines and Geology  
Govt of GOA, PANAJI  
Vide order no/01/593/10-mines/203 Dated: 05/04/2013  
Survey done on 04 DEC 2013

**CERTIFICATE**

This is to certify that the Mining lease boundary pillars of **T. C. No. 28 of 1953** have been surveyed using DGPS (Differential Global Positioning System) based up on The Total Station survey conducted earlier.

Mr. Shirish Malge  
(Owner)

**CERTIFICATE**

This is to certify that the boundary pillars of **T. C. No. 28 of 1953** as shown by **Mr. Shirish Malge (Owner)** has been surveyed by our team led by **Mr. C. Ganesan** using DGPS (Differential Global Positioning System) instruments. The lease map and pillar locations have been verified, survey conducted and plans prepared as per requirement of IBM circular No.2 /2010 Dated 06-04-2010.

For Geofiny Technologies (P) Ltd.  
C. Ganesan (Geologist)

Directorate of Mines & Geology, Panaji - Goa

|                   |                             |
|-------------------|-----------------------------|
| Checked By        | Certified By                |
| <br><br>          | <br><br>                    |
| Surveying Officer | Director of Mines & Geology |

